

PART NUMBER	DESCRIPTION	MATERIAL
FP-LL STRAP 9.8125	LEVEL LOK MOUNTING STRAP 9-13/16"	ST-FI 3/8x2-3/4"

REV.	REVISIONS	DATE	APPROVED
A	DESCRIPTION INITIAL RELEASE	1/21/13	

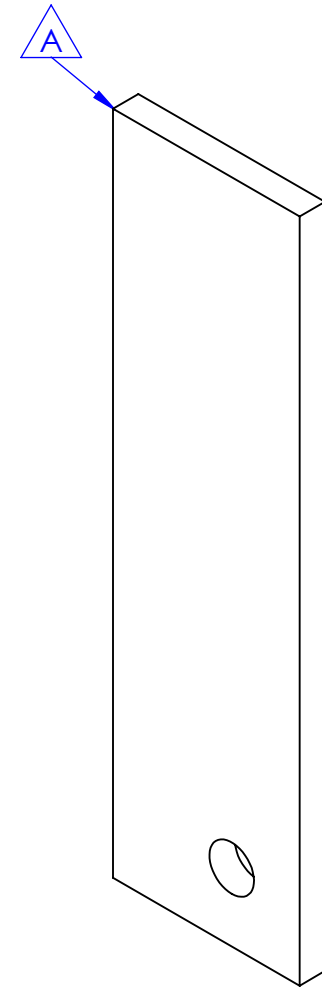
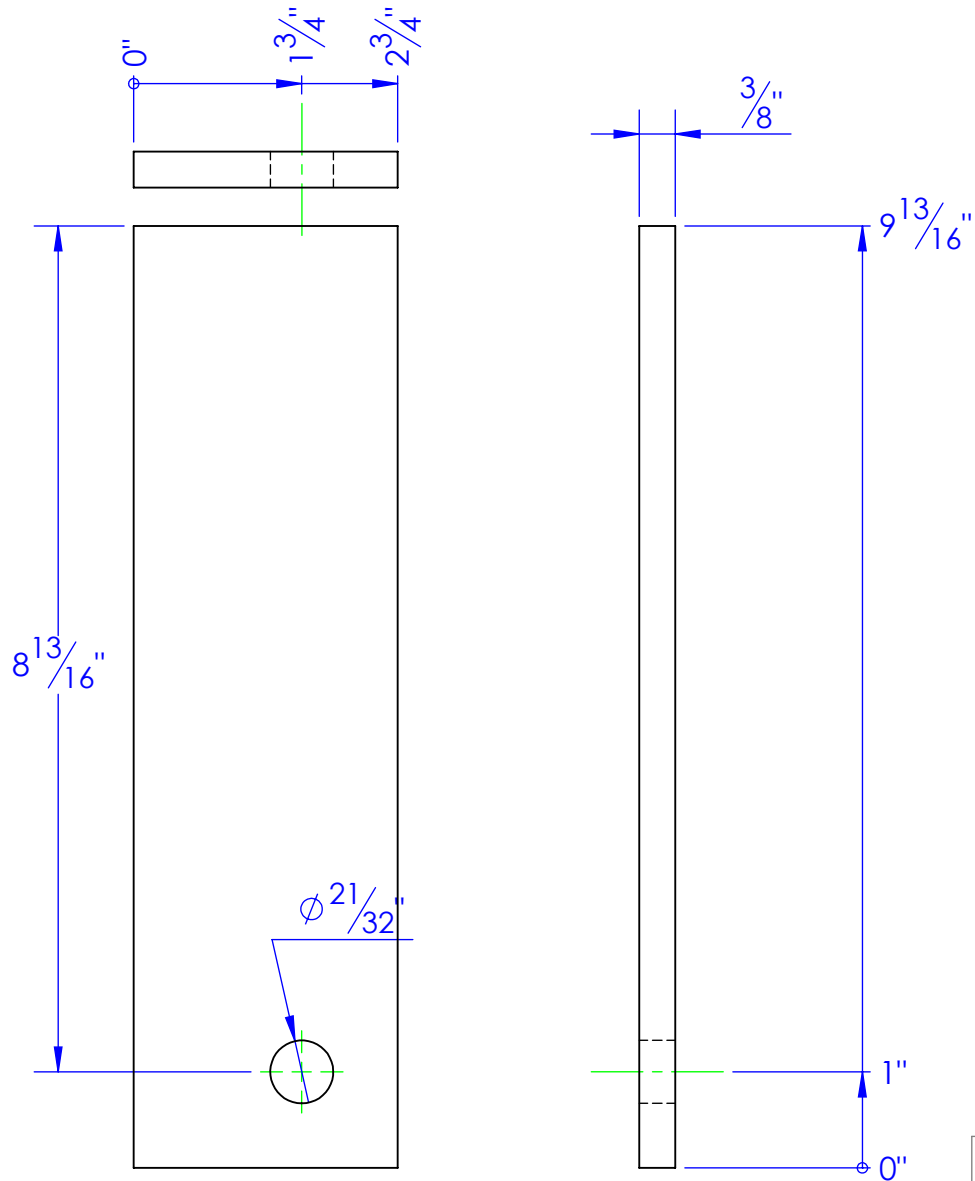

**PROPRIETARY AND CONFIDENTIAL**  
 THE INFORMATION CONTAINED IN THIS  
 DRAWING IS THE SOLE PROPERTY OF TRIPLE  
 C INC. ANY REPRODUCTION IN PART OR  
 AS A WHOLE WITHOUT THE WRITTEN  
 PERMISSION OF TRIPLE C INC. IS PROHIBITED.

DIMENSIONS ARE IN INCHES TOLERANCES: FRACTIONAL $\pm 1/16$ ANGULAR: MACH $\pm 1$ BEND $\pm$ TWO PLACE DECIMAL $\pm 0.010$ THREE PLACE DECIMAL $\pm 0.005$			NAME	DATE
DRAWN		HEATH	1/22/2013	
PART #		FP-LL STRAP 9.8125		
ASM #				
COMMENTS:				
LEVEL LOK MOUNTING STRAP 9-13/16"				
MATERIAL ST-FI 3/8x2-3/4"				
DO NOT SCALE DRAWING				

P.O. BOX 248,  
SABETHA, KS 66534

**TRIPLE C**  
INC.

SIZE <b>A</b>	DWG. NO. <b>90-2824 A</b>	REV. <b>A</b>
SCALE: 1:2	WEIGHT: 2.83	SHEET 1 OF 1